



LOWBAR1

Dimensions (mm)	External	Internal
Height	840	
Width	598	
Depth	520	
Capacity (ltr)		
Gross		108BTL/117L
Net		99L



LOWBAR2

Dimensions (mm)	External	Internal
Height	840	
Width	903	
Depth	520	
Capacity (ltr)		
Gross		168BTL/182L
Net		141L



LOWBAR2SL

Dimensions (mm)	External	Internal
Height	840	
Width	903	
Depth	511	
Capacity (ltr)		
Gross		168BTL/181L
Net		141L



LOWBAR3

Dimensions (mm)	External	Internal
Height	840	
Width	1353	
Depth	520	
Capacity (ltr)		
Gross		276BTL/280L
Net		220L



LOWBAR3SL

Dimensions (mm)	External	Internal
Height	840	
Width	1353	
Depth	511	
Capacity (ltr)		
Gross		276BTL/280L
Net		220L

Features

- Black laminated exterior; Aluminium stippled interior
- Self closing, double glazed door (s)
- 2 adjustable shelves per door
- Lock fitted as standard
- Internal LED illumination
- Replaceable door gasket
- Optional - chrome plated scalloped wine shelf (each shelf holds 5 bottles)

Additional Extras

- W4-SHELF01 - Shelf for LOWBAR1
- W4-SHELF02 - Shelf for LOWBAR2(SL)/3(SL)
- W4-SHELF04 - Shelf middle for LOWBAR2(SL)
- W4-SHELF05 - Wine Shelf for LOWBAR1
- W4-SHELF06 - Wine Shelf for LOWBAR2(SL)/3(SL)
- W4-SHELF07 - Wine Shelf Middle for LOWBAR3(SL)
- W4-SEAL04A - Gasket for LOWBAR2/3
- W4-SEAL03A - Gasket for LOWBAR1
- W4-CLIP01 - Shelf Clip (4 per shelf)



Technical Specification

	LOWBAR1	LOWBAR2	LOWBAR2SL	LOWBAR3	LOWBAR3SL
Temperature Range	+4°C ~ -12°C	+4°C ~ -12°C	+4°C ~ -12°C	+4°C ~ -12°C	+4°C ~ -12°C
Climate Class	4	4	4	4	4
Power Supply	13amp	13amp	13amp	13amp	13amp
Cooling	Fan assisted	Fan assisted	Fan assisted	Fan assisted	Fan assisted
Defrost	Automatic	Automatic	Automatic	Automatic	Automatic
Noise Level	53db	56db	57db	59db	59db
Refrigerant	R600a	R600a	R600a	R600a	R600a
Energy Efficiency Class	D	D	E	F	G
Energy Consumption (kw/24hrs)	1.40	1.70	1.90	3.80	4.30
Power Usage (w)	125	140	140	270	270
Weight (kg)	44	59	59	91	91

LOWBAR1

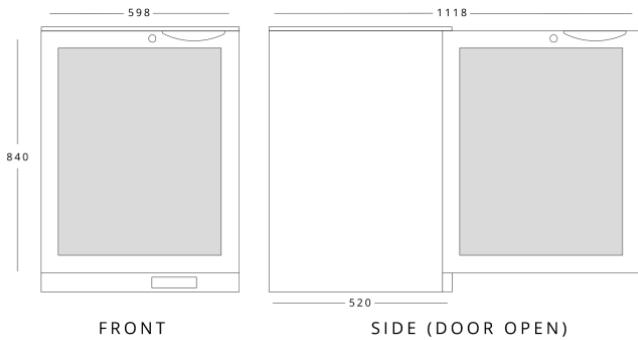

LOWBAR2

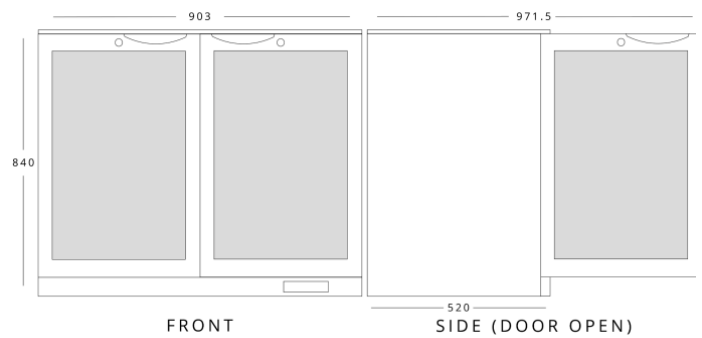

LOWBAR2SL

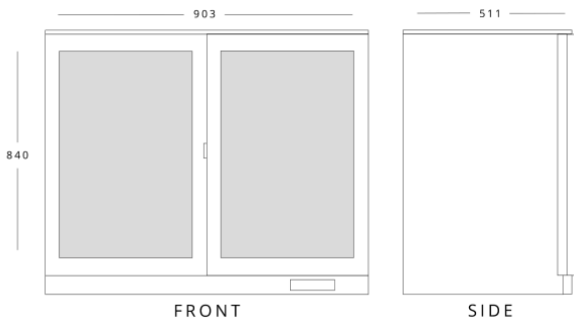

LOWBAR3

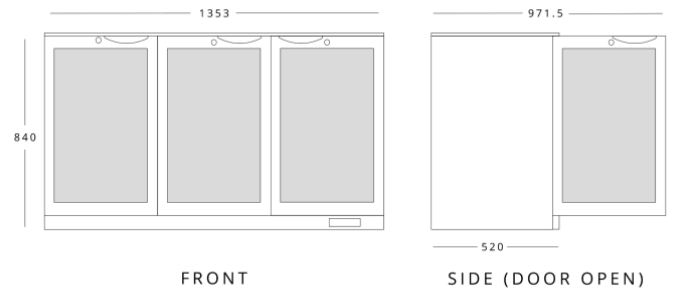

LOWBAR3SL

