



BAR1

Dimensions (mm)	External	Internal
Height	900	
Width	598	
Depth	520	
Capacity (ltr)		
Gross		135BTL/128L
Net		110L



BAR2

Dimensions (mm)	External	Internal
Height	900	
Width	903	
Depth	520	
Capacity (ltr)		
Gross		202BTL/200L
Net		159L



BAR2SL

Dimensions (mm)	External	Internal
Height	900	
Width	903	
Depth	511	
Capacity (ltr)		
Gross		202BTL/200L
Net		159L



BAR3

Dimensions (mm)	External	Internal
Height	900	
Width	1353	
Depth	520	
Capacity (ltr)		
Gross		338BTL/310L
Net		248L



BAR3SL

Dimensions (mm)	External	Internal
Height	900	
Width	1353	
Depth	511	
Capacity (ltr)		
Gross		338BTL/310L
Net		248L

Features

- Black laminated exterior; Aluminium stippled interior
- Self closing, double glazed door (s)
- 2 adjustable shelves per door
- Lock fitted as standard
- Internal LED illumination
- Replaceable door gasket
- Optional - chrome plated scalloped wine shelf (each shelf holds 4 bottles)

Additional Extras

- W4-SHELF01 - Shelf for BAR1
- W4-SHELF02 - Shelf for BAR2(SL)+BAR3(SL)
- W4-SHELF04 - Middle shelf for BAR3(SL)
- W4-SHELF05 - Wine shelf for BAR1
- W4-SHELF06 - Wine shelf for BAR2(SL)+3(SL)
- W4-SHELF07 - Wine shelf middle for BAR3(SL)
- W4-SEAL01A - Gasket for BAR1
- W4-SEAL02A - Gasket for BAR2,3
- W4-CLIP01 - Shelf clip (4 per shelf)
- W4-SEAL02A - Gasket for BAR2,3

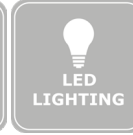

Technical Specification

	BAR1	BAR2	BAR2SL	BAR3	BAR3SL
Temperature Range	+4°C ~ +12°C	+4°C ~ +12°C	+4°C ~ +12°C	+4°C ~ +12°C	+4°C ~ +12°C
Climate Class	4	4	4	4	4
Power Supply	13amp	13amp	13amp	13amp	13amp
Cooling	Fan assisted	Fan assisted	Fan assisted	Fan assisted	Fan assisted
Defrost	Automatic	Automatic	Automatic	Automatic	Automatic
Noise Level	53db	54db	54db	59db	59db
Refrigerant	R600A	R600A	R600A	R600A	R600A
Energy Efficiency Class	D	D	D	F	F
Energy Consumption (kw/24hrs)	1.50	1.80	2.00	4.00	4.50
Power Usage (w)	165	185	185	320	320
Weight (kg)	44	59	59	91	91

BAR1

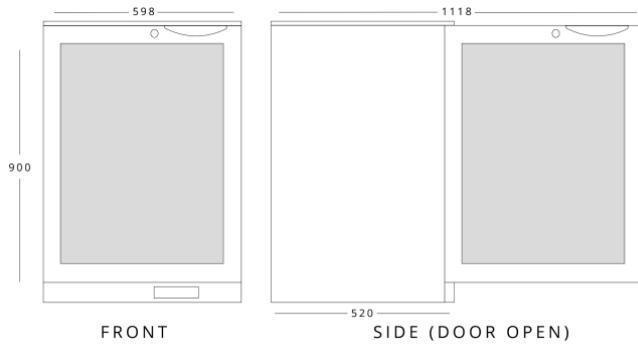

BAR2

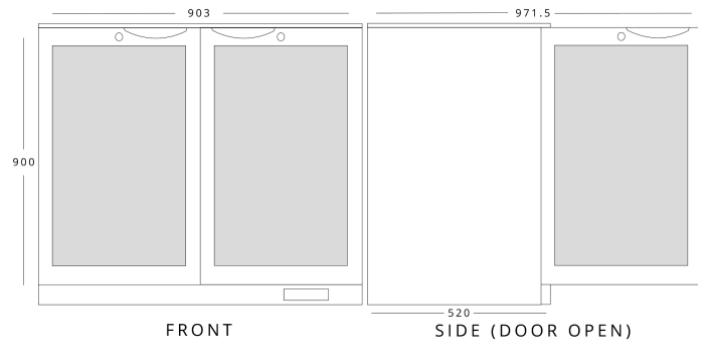

BAR2SL

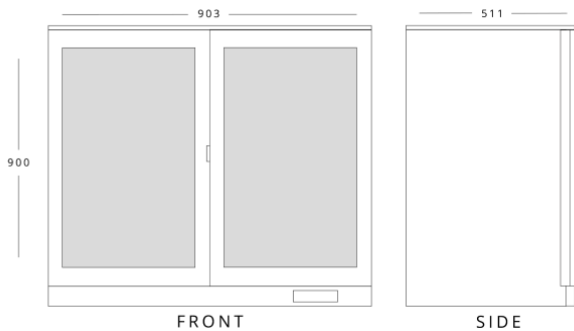

BAR3

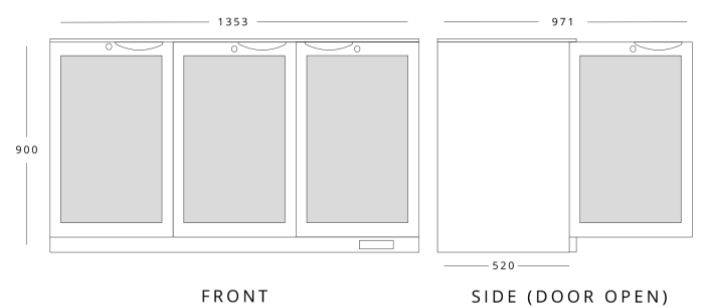

BAR3SL

