

BPB1500/2000XX

Exploded parts diagram

Image shown is BPB2000XX

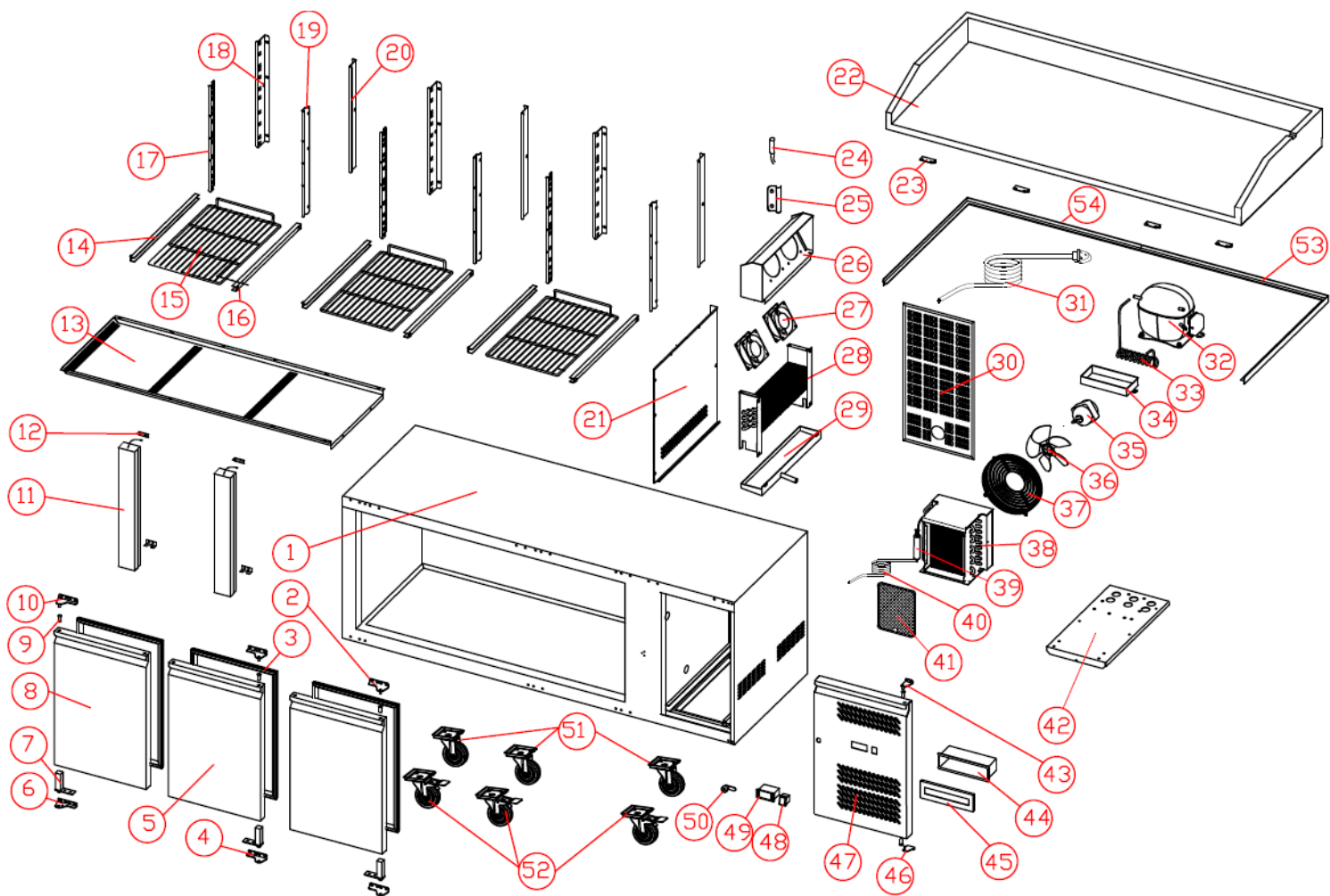





| Part Number | Number | Description | Qty |
|---------------|--------|--|-----|
| *** | 1 | Cabinet | 1 |
| X1-HINGE13 | 2 | RH Upper Hinge (BPB2000XX) | 2 |
| X1-HINGE13 | 2 | RH Upper Hinge (BPB1500XX) | 1 |
| B1-GASKET27 | 3 | Door Gasket (BPB2000XX) | 3 |
| B1-GASKET27 | 3 | Door Gasket (BPB1500XX) | 2 |
| X1-HINGE14 | 4 | RH Bottom Hinge (BPB2000XX) | 2 |
| X1-HINGE14 | 4 | RH Bottom Hinge (BPB1500XX) | 1 |
| X1-DOOR09N | 5 | Door (right) (BPB2000XX) *Please check cabinet Mark* | 2 |
| X1-DOOR09N | 5 | Door (right) (BPB1500XX) *Please check cabinet Mark* | 1 |
| X1-HINGE15 | 6 | LH Bottom Hinge (BPB1500/2000XX) | 1 |
| *** | 7 | Spring Hinge (BPB2000XX) | 3 |
| *** | 7 | Spring Hinge (BPB1500XX) | 2 |
| X1-DOOR08N | 8 | Door (left) (BPB1500/2000XX) *Please check cabinet Mark* | 1 |
| K8-AXISSLEEVE | 9 | Bush (BPB2000XX) | 5 |
| K8-AXISSLEEVE | 9 | Bush (BPB1500XX) | 4 |
| X1-HINGE16 | 10 | LH Upper Hinge (BPB1500/2000XX) | 1 |
| *** | 11 | Mullion (BPB2000XX) | 2 |
| *** | 11 | Mullion (BPB1500XX) | 1 |
| *** | 12 | Mullion Connector (BPB2000XX) | 4 |
| *** | 12 | Mullion Connector (BPB1500XX) | 2 |
| *** | 13 | Air Guide Board (BPB1500/2000XX) | 1 |
| X1-GUIDE03 | 14 | Left Shelf Guide (BPB2000XX) (Pair) | 3 |
| X1-GUIDE03 | 14 | Left Shelf Guide (BPB1500XX) (Pair) | 2 |
| X1-SHELF09 | 15 | Shelf (BPB2000XX) | 3 |
| X1-SHELF09 | 15 | Shelf (BPB1500XX) | 2 |
| X1-GUIDE03 | 16 | Right Shelf Guide (BPB2000XX) (Pair) | 3 |
| X1-GUIDE03 | 16 | Right Shelf Guide (BPB1500XX) (Pair) | 2 |
| *** | 17 | Ladder Rack (left) (BPB2000XX) | 3 |
| *** | 17 | Ladder Rack (left) (BPB1500XX) | 2 |
| *** | 18 | Rear Ladder Rack (left) (BPB2000XX) | 3 |
| *** | 18 | Rear Ladder Rack (left) (BPB1500XX) | 2 |
| *** | 19 | Ladder Rack (right) (BPB2000XX) | 3 |
| *** | 19 | Ladder Rack (right) (BPB1500XX) | 2 |
| *** | 20 | Rear Ladder Rack(right) (BPB2000XX) | 3 |
| *** | 20 | Rear Ladder Rack(right) (BPB1500XX) | 2 |
| *** | 21 | Evap Cover (BPB1500/2000XX) | 1 |
| *** | 22 | Granite Top (BPB1500/2000XX) | 1 |
| *** | 23 | Top Fixing Plate (BPB1500/2000XX) | 4 |
| K8-PROBE01 | 24 | Probe (BPB1500/2000XX) | 1 |
| *** | 25 | Probe Cover (BPB1500/2000XX) | 1 |
| *** | 26 | Evap Fan Cover (BPB1500/2000XX) | 1 |
| X1-FAN03 | 27 | Evap Fan (BPB1500/2000XX) | 2 |
| X1-EVAP06 | 28 | Evaporator (BPB1500/2000XX) | 1 |
| *** | 29 | Evap Drip tray (BPB1500/2000XX) | 1 |
| *** | 30 | Back Cover (BPB1500/2000XX) | 1 |

| | | | |
|-----------------|----|--|---|
| *** | 31 | Power Cord (BPB1500/2000XX) | 1 |
| X1-COMP05 | 32 | Compressor (BPB2000XX) | 1 |
| X1-COMP06 | 32 | Compressor (BPB1500XX) | 1 |
| *** | 33 | Vaporising Coil (BPB1500/2000XX) | 1 |
| *** | 34 | Vaporising Tray (BPB1500/2000XX) | 1 |
| X1-FAN01 | 35 | Cond Fan motor (BPB1500/2000XX) | 1 |
| K8-BLADE01 | 36 | Cond Fan Blade (BPB1500/2000XX) | 1 |
| *** | 37 | Cond Fan cover (BPB1500/2000XX) | 1 |
| *** | 38 | Condenser (BPB1500/2000XX) | 1 |
| *** | 39 | Drier (BPB1500/2000XX) | 1 |
| X1-CAPILLARY04 | 40 | Capillary (BPB1500/2000XX) | 1 |
| *** | 41 | Cond Filter (BPB1500/2000XX) | 1 |
| *** | 42 | Cooling Unit Board (BPB1500/2000XX) | 1 |
| *** | 43 | Control Panel Upper Hinge (BPB1500/2000XX) | 1 |
| *** | 44 | Plastic Water-proof Box (BPB1500/2000XX) | 1 |
| *** | 45 | Plastic Water-proof Box Cover (BPB1500/2000XX) | 1 |
| *** | 46 | Control Panel Bottom Hinge (BPB1500/2000XX) | 1 |
| X1-DOOR/COND | 47 | Panel (BPB1500/2000XX) | 1 |
| X1-SWITCH01 | 48 | Power Switch (BPB1500/2000XX) | 1 |
| X1-CONTROLLER04 | 49 | Controller (BPB1500/2000XX) | 1 |
| X1-LOCK04 | 50 | Door Lock (BPB1500/2000XX) | 1 |
| *** | 51 | Unbraked Castors (BPB2000XX) | 3 |
| *** | 51 | Unbraked Castors (BPB1500XX) | 2 |
| *** | 52 | Braked Castors (BPB2000XX) | 3 |
| *** | 52 | Braked Castors (BPB1500XX) | 2 |
| *** | 53 | Metal Frame Right | 1 |
| *** | 54 | Metal Frame Left | 1 |

*** Please contact Spare for assistance ***