

BPB1500-7N/2000-7NXX

Exploded parts diagram

Image shown is BPB2000-7NXX

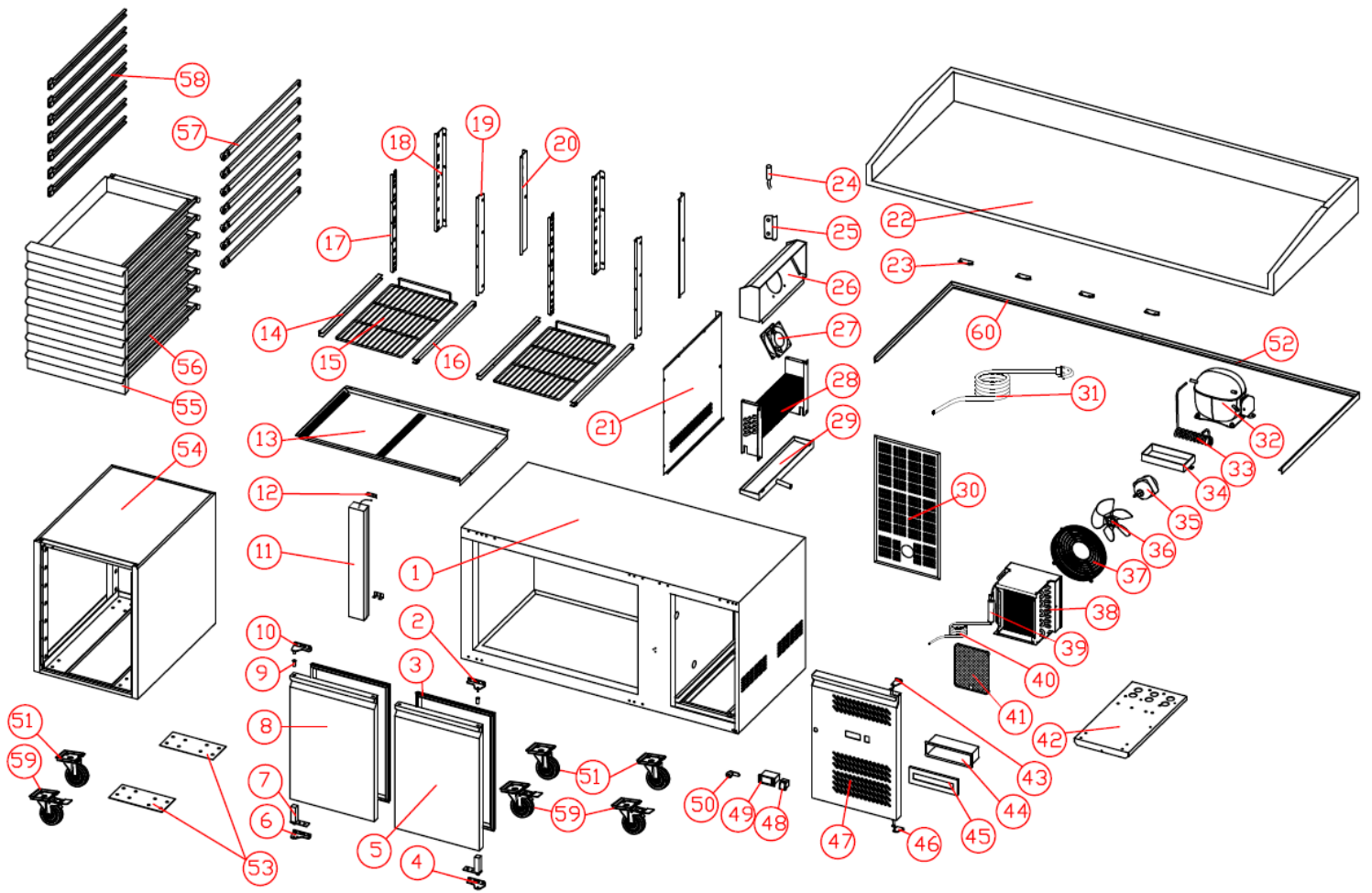





Part Number	Number	Description	Qty
***	1	Cabinet	1
X1-HINGE13	2	RH Upper Hinge (BPB2000-7NXX)	2
X1-HINGE13	2	RH Upper Hinge (BPB1500-7NXX)	1
B1-GASKET27	3	Door Gasket (BPB2000-7NXX)	3
B1-GASKET27	3	Door Gasket (BPB1500-7NXX)	2
X1-HINGE14	4	RH Bottom Hinge (BPB2000-7NXX)	2
X1-HINGE14	4	RH Bottom Hinge (BPB1500-7NXX)	1
X1-DOOR09N	5	Door (right) (BPB2000-7NXX) *Please check cabinet Mark*	2
X1-DOOR09N	5	Door (right) (BPB1500-7NXX) *Please check cabinet Mark*	1
X1-HINGE15	6	LH Bottom Hinge (BPB1500-7N/2000-7NXX)	1
***	7	Spring Hinge (BPB2000-7NXX)	3
***	7	Spring Hinge (BPB1500-7NXX)	2
X1-DOOR08N	8	Door (left) (BPB1500-7N/2000-7NXX) *Please check cabinet Mark*	1
K8-AXISSLEEVE	9	Bush (BPB2000-7NXX)	5
K8-AXISSLEEVE	9	Bush (BPB1500-7NXX)	4
X1-HINGE16	10	LH Upper Hinge (BPB1500-7N/2000-7NXX)	1
***	11	Mullion (BPB2000-7NXX)	2
***	11	Mullion (BPB1500-7NXX)	1
***	12	Mullion Connector (BPB2000-7NXX)	4
***	12	Mullion Connector (BPB1500-7NXX)	2
***	13	Air Guide Board (BPB1500-7N/2000-7NXX)	1
X1-GUIDE03	14	Left Shelf Guide (BPB2000-7NXX) (Pair)	3
X1-GUIDE03	14	Left Shelf Guide (BPB1500-7NXX) (Pair)	2
B1-SHELF03	15	Shelf (BPB2000-7NXX)	3
B1-SHELF03	15	Shelf (BPB1500-7NXX)	2
X1-GUIDE03	16	Right Shelf Guide (BPB2000-7NXX) (Pair)	3
X1-GUIDE03	16	Right Shelf Guide (BPB1500-7NXX) (Pair)	2
***	17	Ladder Rack (left) (BPB2000-7NXX)	3
***	17	Ladder Rack (left) (BPB1500-7NXX)	2
***	18	Rear Ladder Rack (left) (BPB2000-7NXX)	3
***	18	Rear Ladder Rack (left) (BPB1500-7NXX)	2
***	19	Ladder Rack (right) (BPB2000-7NXX)	3
***	19	Ladder Rack (right) (BPB1500-7NXX)	2
***	20	Rear Ladder Rack(right) (BPB2000-7NXX)	3
***	20	Rear Ladder Rack(right) (BPB1500-7NXX)	2
***	21	Evap Cover (BPB1500-7N/2000-7NXX)	1
***	22	Granite Top (BPB1500-7N/2000-7NXX)	1
***	23	Top Fixing Plate (BPB1500-7N/2000-7NXX)	4
K8-PROBE01	24	Probe (BPB1500-7N/2000-7NXX)	1
***	25	Probe Cover (BPB1500-7N/2000-7NXX)	1
***	26	Evap Fan Cover (BPB1500-7N/2000-7NXX)	1
X1-FAN03	27	Evap Fan (BPB1500-7N/2000-7NXX)	2
X1-EVAP06	28	Evaporator (BPB1500-7N/2000-7NXX)	1
***	29	Evap Drip tray (BPB1500-7N/2000-7NXX)	1
***	30	Back Cover (BPB1500-7N/2000-7NXX)	1

***	31	Power Cord (BPB1500-7N/2000-7NXX)	1
X1-COMP06	32	Compressor (BPB1500-7N/2000XX)	1
***	33	Vaporising Coil (BPB1500-7N/2000-7NXX)	1
***	34	Vaporising Tray (BPB1500-7N/2000-7NXX)	1
X1-FAN01	35	Cond Fan motor (BPB1500-7N/2000-7NXX)	1
K8-BLADE01	36	Cond Fan Blade (BPB1500-7N/2000-7NXX)	1
***	37	Cond Fan cover (BPB1500-7N/2000-7NXX)	1
***	38	Condenser (BPB1500-7N/2000-7NXX)	1
***	39	Drier (BPB1500-7N/2000-7NXX)	1
X1-CAPILLARY04	40	Capillary (BPB1500-7N/2000-7NXX)	1
***	41	Cond Filter (BPB1500-7N/2000-7NXX)	1
***	42	Cooling Unit Board (BPB1500-7N/2000-7NXX)	1
***	43	Control Panel Upper Hinge (BPB1500-7N/2000-7NXX)	1
***	44	Plastic Water-proof Box (BPB1500-7N/2000-7NXX)	1
***	45	Plastic Water-proof Box Cover (BPB1500-7N/2000-7NXX)	1
***	46	Control Panel Bottom Hinge (BPB1500-7N/2000-7NXX)	1
X1-DOOR/COND	47	Panel (BPB1500-7N/2000-7NXX)	1
X1-SWITCH01	48	Power Switch (BPB1500-7N/2000-7NXX)	1
X1-CONTROLLER04	49	Controller (BPB1500-7N/2000-7NXX)	1
X1-LOCK04	50	Door Lock (BPB1500-7N/2000-7NXX)	1
***	51	Unbraked Castors (BPB2000-7NXX)	3
***	52	Metal Frame Right	1
***	53	Connecting Plate	2
***	54	Ambient Box	1
***	55	Drawer Fascia	7
***	56	Drawer Carcass	7
X1-BOXGUIDERH	57	Drawer Guides Right	7
X1-BOXGUIDELH	58	Drawer Guides Left	7
***	59	Braked Castors	3
***	60	Metal Frame Left	1

*** Please contact Spare for assistance ***